



# HODSONS



ASKING PRICE

**£350,000**

**Pontefract Road**

Pontefract, WF7 7LL





## PROPERTY SUMMARY

This is a substantial detached true bungalow which is offered to the market with no onward chain.

The well presented living accommodation will appeal to buyers who are looking for a bungalow which is large enough for visiting family and friends and it is ideal for entertaining.

A spacious hall with storage cupboards give access to a lounge, separate dining room (possible fourth bedroom) kitchen with range of quality units in Oak, three double bedrooms (one en suite) and a main house bathroom.

The bungalow stands within a good size plot with mature gardens to both the front and rear. A driveway provides ample off road parking and leads to an attached garage with conservatory/studio beyond.

Ackworth is a most desirable village and home to some of the finest residential property in the area. The village's popularity stems from its convenient location, which is ideal for commuters, and its attractive rolling landscape. Ackworth is also home to a good selection of shops, a small supermarket, garden centre and public houses together with 'Ackworth School', which is one of the area's leading independent boarding schools.

3



2



2















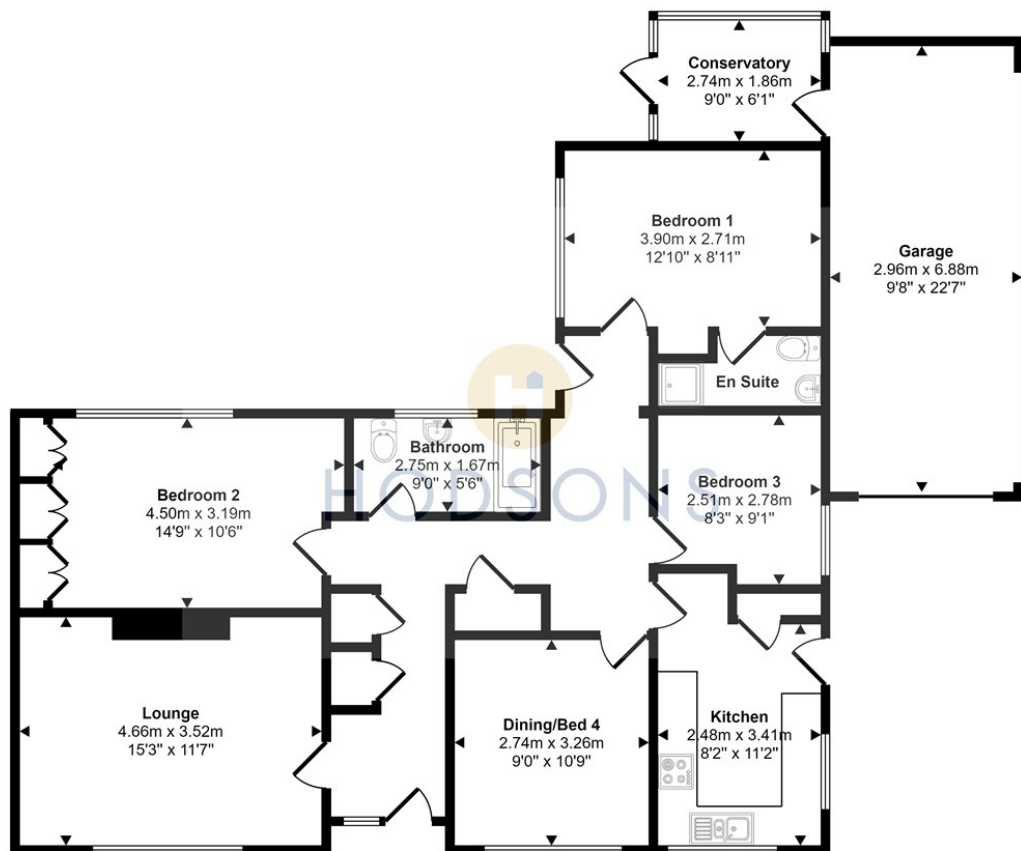

Floorplan

This floorplan is only for illustrative purposes and is not to scale. Measurements of rooms, doors, windows, and any items are approximate and no responsibility is taken for any error, omission or mis-statement. Icons of items such as bathroom suites are representations only and may not look like the real items. Made with Made Snappy 360.

#### LOCAL AUTHORITY

Wakefield Metropolitan District council

#### TENURE

Freehold

#### COUNCIL TAX BAND

E

#### VIEWINGS

By prior appointment only

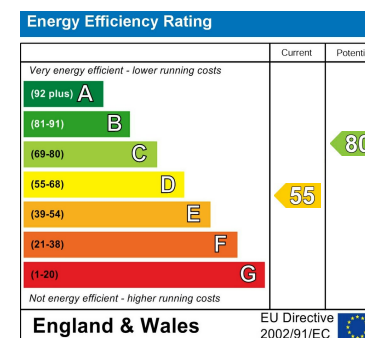

Agents Note: Whilst every care has been taken to prepare these particulars, they are for guidance purposes only. All measurements are approximate and are for general guidance purposes only and whilst every care has been taken to ensure their accuracy, they should not be relied upon and potential buyers/tenants are advised to recheck the measurements



#### OFFICE ADDRESS

37-39 George Street  
Wakefield  
West Yorkshire  
WF1 1LX

#### OFFICE DETAILS

01924 200544  
wakefield@hodsonsproperty.co.uk  
www.hodsonsproperty.co.uk