



HODSONS

ASKING PRICE

£330,000

Mountbatten Avenue

Wakefield, WF2 6HE



PROPERTY SUMMARY

SIGNIFICANT REDUCTION BY MOTIVATED SELLERS Welcome to Mountbatten Avenue, Sandal a charming and well-presented four-bedroom detached home in a highly sought-after residential area. This property boasts a contemporary fitted kitchen and a modern bathroom, perfect for those who are looking for a home ready to move in to.

The low maintenance gardens at the front and rear of the property provide a lovely outdoor space to relax and unwind. The driveway to the front and side offer ample off-road parking leading to a detached garage.

Inside, you'll find a spacious lounge and a separate dining room, ideal for entertaining friends and family. The convenience of a ground floor W.C adds a practical touch to this already impressive home.

Situated in a popular location, this property is close to amenities including schools catering to all age groups. For commuters, the easy access to the motorway network makes this home an ideal base for those who need to travel for work.

Don't miss out on the opportunity to make this delightful property your new home.

4



1



2









LOCAL AUTHORITY

Wakefield

TENURE

Freehold

COUNCIL TAX BAND

D

VIEWINGS

By prior appointment only



Approx Gross Internal Area
93 sq m / 1002 sq ft

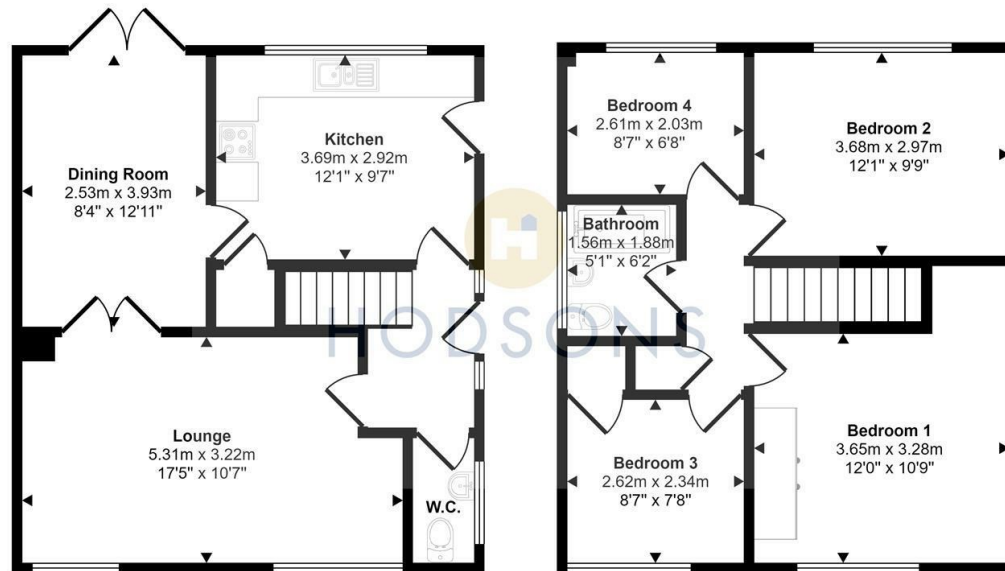

This floorplan is only for illustrative purposes and is not to scale. Measurements of rooms, doors, windows, and any items are approximate and no responsibility is taken for any error, omission or mis-statement. Icons of items such as bathroom suites are representations only and may not look like the real items. Made with Made Snappy 360.

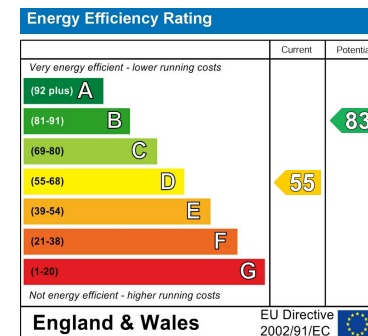

Agents Note: Whilst every care has been taken to prepare these particulars, they are for guidance purposes only. All measurements are approximate and are for general guidance purposes only and whilst every care has been taken to ensure their accuracy, they should not be relied upon and potential buyers/tenants are advised to recheck the measurements

**OFFICE ADDRESS**

37-39 George Street
Wakefield
West Yorkshire
WF1 1LX

OFFICE DETAILS

01924 200544
wakefield@hodsonsproperty.co.uk
www.hodsonsproperty.co.uk