



HODSONS



PER MONTH

£925 Per Month

Dalton Grove

Leeds, LS11 7NH



PROPERTY SUMMARY

Situated within a popular location in Beeston. Located close by to all amenities, Leeds City Centre and nearby Motorway Links. The property benefits Lounge with electric fire, dining kitchen with oven/hob/extractor, understairs cupboard, stairs & landing, two double bedrooms and a house bathroom/WC with shower. Yards to front & rear. Attached garage with possible off street parking space (subject to car size) plenty of on street parking.

2



1



1



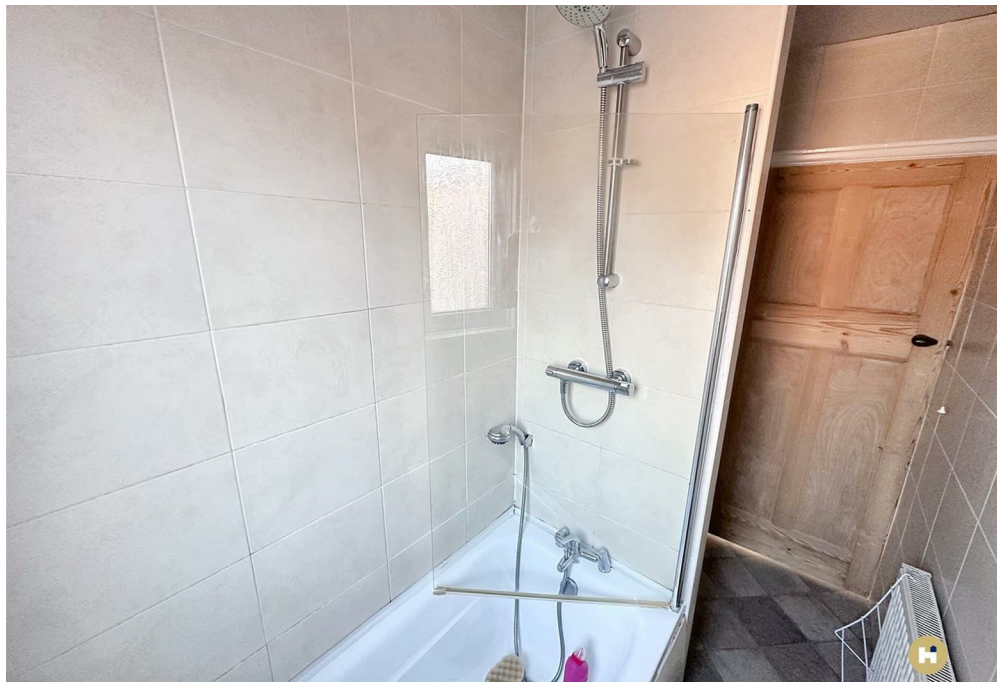

Approx Gross Internal Area
63 sq m / 674 sq ft

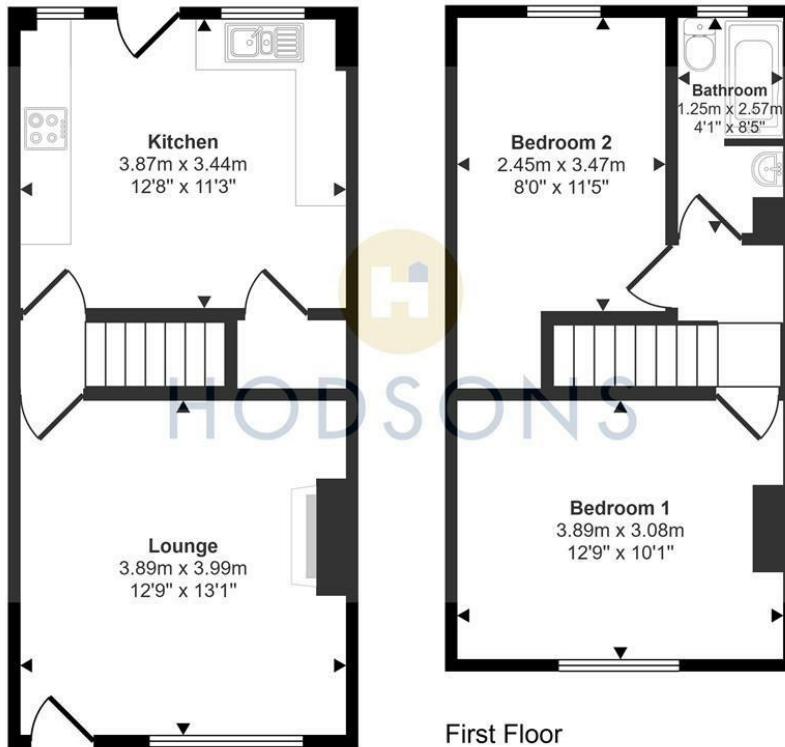

Ground Floor
Approx 33 sq m / 357 sq ft

First Floor
Approx 29 sq m / 317 sq ft

This floorplan is only for illustrative purposes and is not to scale. Measurements of rooms, doors, windows, and any items are approximate and no responsibility is taken for any error, omission or mis-statement. Icons of items such as bathroom suites are representations only and may not look like the real items. Made with Made Snappy 360.

LOCAL AUTHORITY
LeedsCity Council

TENURE

COUNCIL TAX BAND
A

VIEWINGS
By prior appointment only

Energy Efficiency Rating		Current	Potential
Very energy efficient - lower running costs			
(92 plus) A			87
(81-91) B			
(69-80) C			
(55-68) D		63	
(39-54) E			
(21-38) F			
(1-20) G			
Not energy efficient - higher running costs			
England & Wales		EU Directive 2002/91/EC	

Agents Note: Whilst every care has been taken to prepare these particulars, they are for guidance purposes only. All measurements are approximate and are for general guidance purposes only and whilst every care has been taken to ensure their accuracy, they should not be relied upon and potential buyers/tenants are advised to recheck the measurements



OFFICE ADDRESS
37-39 George Street
Wakefield
West Yorkshire
WF1 1LX

OFFICE DETAILS
01924 200544
wakefield@hodsonsproperty.co.uk
www.hodsonsproperty.co.uk