



HODSONS



PER MONTH

£1,225 Per Month

Laites Crescent

Wakefield, WF2 9TR



PROPERTY SUMMARY

Welcome to this beautifully presented three-bedroom semi-detached family home, situated in a cul-de-sac in the sought-after residential area of Alverthorpe. This property is ideal for families and professionals alike. Please note photos of the garden are for illustration purposes only. The property is currently being fully redecorated throughout and new carpets will be fitted. A new boiler is due to be installed shortly.

3



1



1





Approx Gross Internal Area
72 sq m / 770 sq ft

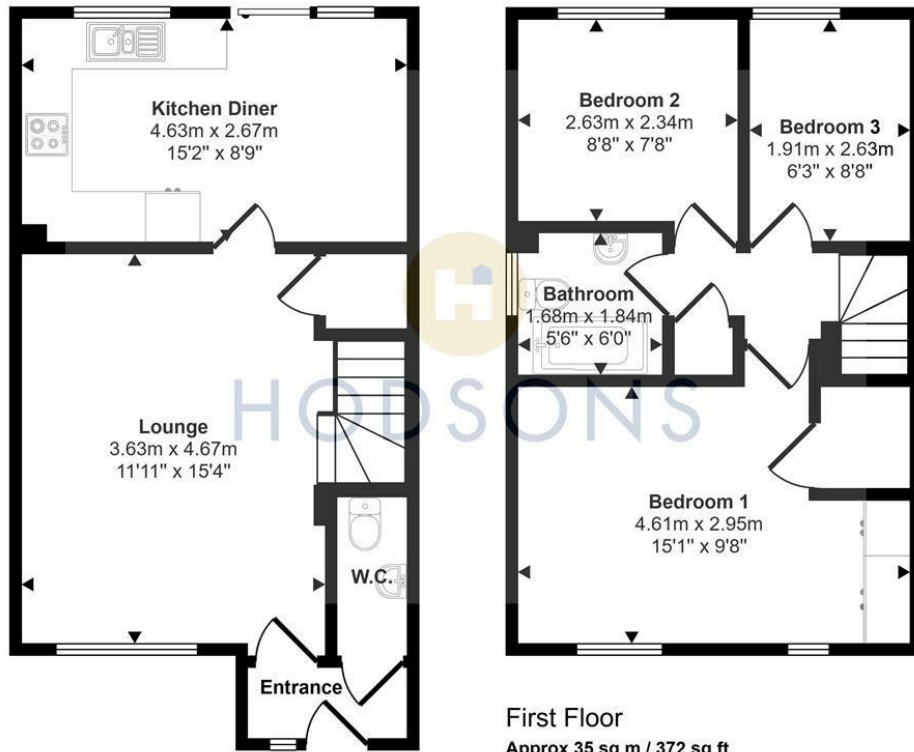

This floorplan is only for illustrative purposes and is not to scale. Measurements of rooms, doors, windows, and any items are approximate and no responsibility is taken for any error, omission or mis-statement. Icons of items such as bathroom suites are representations only and may not look like the real items. Made with Made Snappy 360.

LOCAL AUTHORITY
Wakefield

TENURE

COUNCIL TAX BAND
C

VIEWINGS
By prior appointment only

Energy Efficiency Rating		Current	Potential
Very energy efficient - lower running costs			
(92 plus) A			86
(81-91) B			
(69-80) C		66	
(55-68) D			
(39-54) E			
(21-38) F			
(1-20) G			
Not energy efficient - higher running costs			
England & Wales		EU Directive 2002/91/EC	

Agents Note: Whilst every care has been taken to prepare these particulars, they are for guidance purposes only. All measurements are approximate and are for general guidance purposes only and whilst every care has been taken to ensure their accuracy, they should not be relied upon and potential buyers/tenants are advised to recheck the measurements



OFFICE ADDRESS
37-39 George Street
Wakefield
West Yorkshire
WF1 1LX

OFFICE DETAILS
01924 200544
wakefield@hodsonsproperty.co.uk
www.hodsonsproperty.co.uk