



HODSONS

PCM

£795 PCM

The Pinnacle

Wakefield, WF1 1DE

PROPERTY SUMMARY

A modern two bedroom ground floor apartment within this desirable city centre development. The apartment is ideally placed for access on foot to a vast array of local amenities including Supermarket, City Centre Shopping, Cinema, Restaurants and Westgate Railway Station is only a 5 to 10 minutes walk as is Wakefield bus station for those commuting further afield. The property is inclusive of electric storage heating and in brief comprises: Entrance Hall, Lounge, fitted kitchen with appliances and two bedrooms, bathroom with separate shower cubicle. 1 Parking space no visitor parking

2



1



1





Approx Gross Internal Area
68 sq m / 729 sq ft

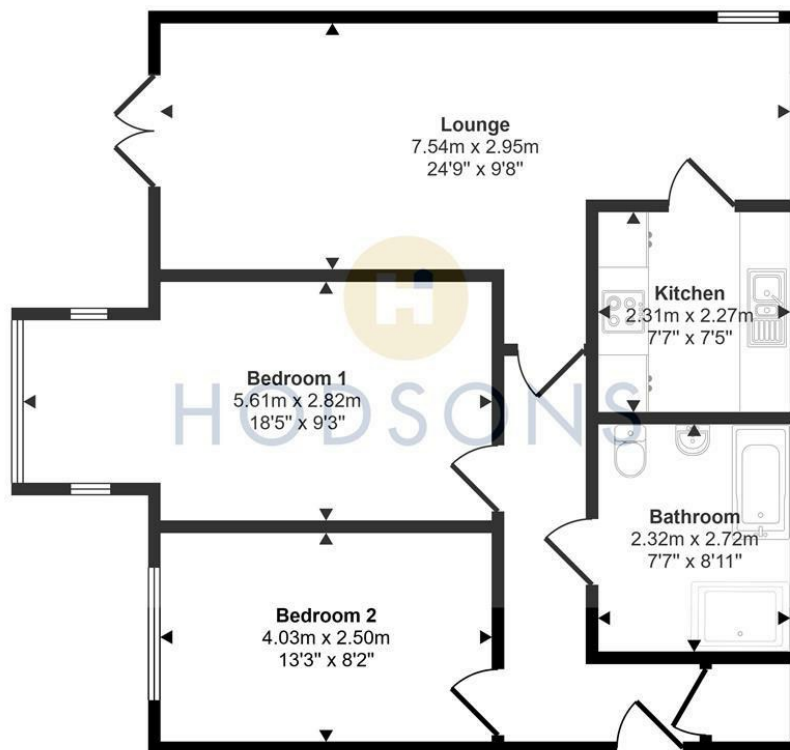

Floorplan

This floorplan is only for illustrative purposes and is not to scale. Measurements of rooms, doors, windows, and any items are approximate and no responsibility is taken for any error, omission or mis-statement. Icons of items such as bathroom suites are representations only and may not look like the real items. Made with Made Snappy 360.

LOCAL AUTHORITY

Wakefield Metropolitan District council

TENURE

COUNCIL TAX BAND

B

VIEWINGS

By prior appointment only

| Energy Efficiency Rating | | |
|---|-------------------------|-----------|
| | Current | Potential |
| Very energy efficient - lower running costs | | |
| (92 plus) A | | |
| (81-91) B | | |
| (69-80) C | | |
| (55-68) D | | |
| (39-54) E | | |
| (21-38) F | | |
| (1-20) G | | |
| Not energy efficient - higher running costs | | |
| England & Wales | EU Directive 2002/91/EC | |

Agents Note: Whilst every care has been taken to prepare these particulars, they are for guidance purposes only. All measurements are approximate and are for general guidance purposes only and whilst every care has been taken to ensure their accuracy, they should not be relied upon and potential buyers/tenants are advised to recheck the measurements



OFFICE ADDRESS

37-39 George Street
Wakefield
West Yorkshire
WF1 1LX

OFFICE DETAILS

01924 200544
wakefield@hodsonsproperty.co.uk
www.hodsonsproperty.co.uk