



HODSONS



ASKING PRICE

£179,950

Tarn Court

Wakefield, WF1 3HG



HODSONS

A particularly well presented semi detached home which has undergone a comprehensive refurbishment programme located in an attractive cul-de-sac setting in the popular area of Outwood in Wakefield.

Well appointed throughout the house is ideal for first time buyers or a young family. Conveniently placed for access to local amenities (including reputable primary and secondary schools) whilst having excellent transport links.

This property has had a complete renovation by the current owner throughout and has had a new kitchen, bathroom, new carpets and new internal doors fitted.

Briefly comprising, entrance hall, a spacious lounge with double doors to the garden, a stunning kitchen with high gloss units, a landing (with built-in storage). Two generous bedrooms, and a single third bedroom, and a impressive contemporary bathroom.

To the rear of the property, there is a private enclosed, low maintenance garden featuring white stone gravel and mature shrubs and fencing offering a good degree of privacy. To the front of the property, there is a private driveway providing ample off-street parking.

Offered to the market with no onward chain a viewing is strongly recommended.

3



1



1





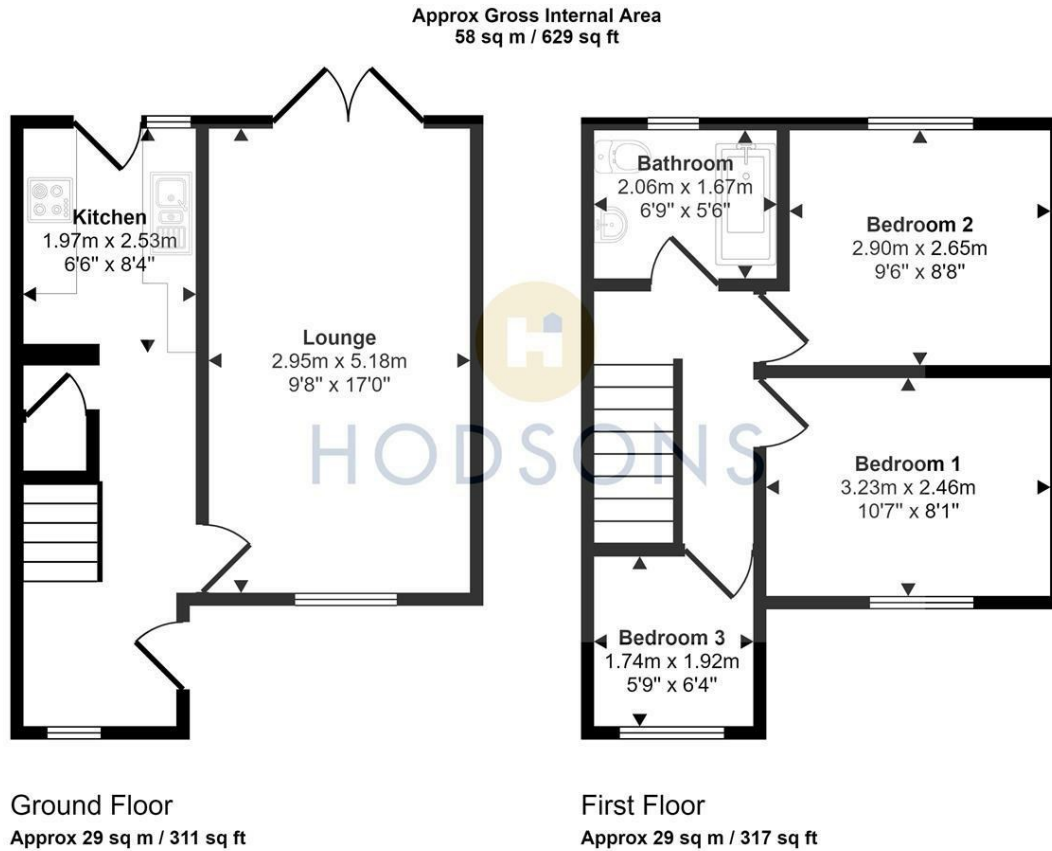

This floorplan is only for illustrative purposes and is not to scale. Measurements of rooms, doors, windows, and any items are approximate and no responsibility is taken for any error, omission or mis-statement. Icons of items such as bathroom suites are representations only and may not look like the real items. Made with Made Snappy 360.

LOCAL AUTHORITY

Wakefield

TENURE

Freehold

COUNCIL TAX BAND

B

VIEWINGS

By prior appointment only

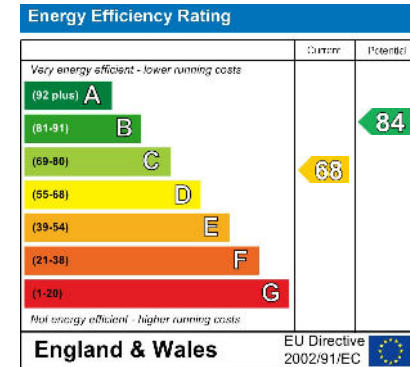

Agents Note: Whilst every care has been taken to prepare these particulars, they are for guidance purposes only. All measurements are approximate and are for general guidance purposes only and whilst every care has been taken to ensure their accuracy, they should not be relied upon and potential buyers/tenants are advised to recheck the measurements



OFFICE ADDRESS
37-39 George Street
Wakefield
West Yorkshire
WF1 1LX

OFFICE DETAILS
01924 200544
wakefield@hodsonsproperty.co.uk
www.hodsonsproperty.co.uk