



HODSONS



ASKING PRICE

£145,000

Park Lodge Lane

Wakefield, WF1 4HX



PROPERTY SUMMARY

This semi detached home occupies a particularly generous plot with three bedroom accommodation ideal for family buyers.

The property has a gas central heating system, UPVC double glazing and briefly comprises; entrance hall, lounge, separate dining room, kitchen and ground floor W.C. To the first floor are three good size bedrooms and bathroom. The property requires a scheme of updating and stands on gardens to front, side and rear providing the opportunity to extend the already substantial accommodation further (subject to the necessary consents).

Conveniently located to access a wide range of amenities including schools for all ages groups, public transport services and a wide choice of retail and recreational facilities in the centre of Wakefield.

3



1



2





LOCAL AUTHORITY

Wakefield

TENURE

Freehold

COUNCIL TAX BAND

A

VIEWINGS

By prior appointment only

Approx Gross Internal Area
89 sq m / 954 sq ft

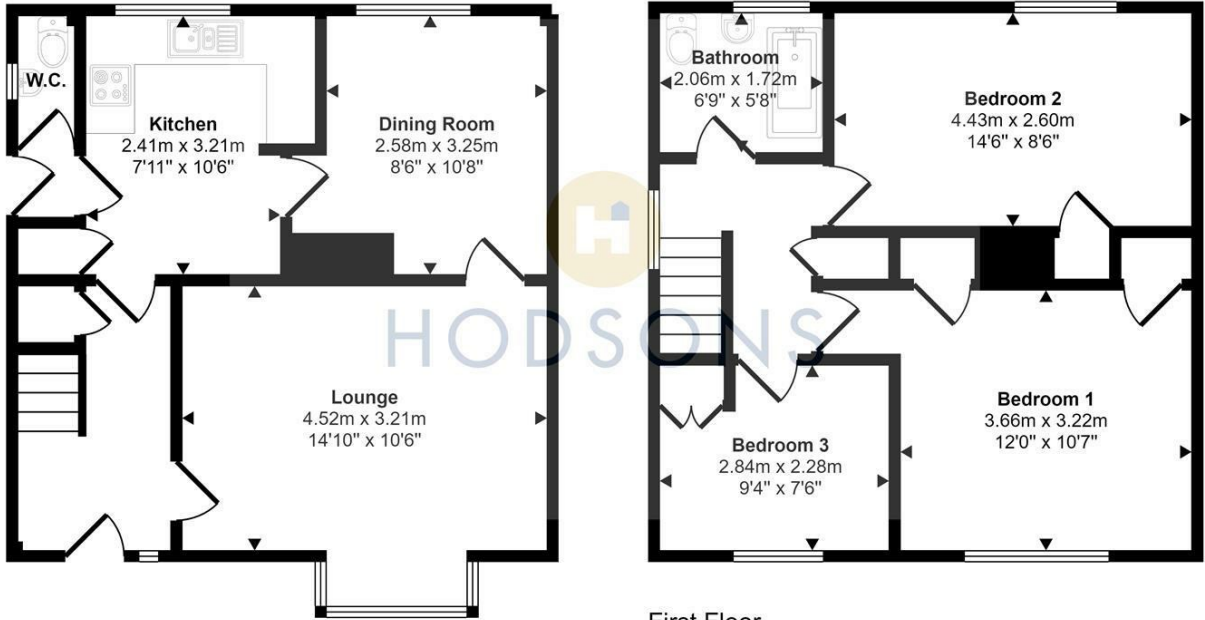

First Floor
Approx 44 sq m / 475 sq ft

Ground Floor
Approx 44 sq m / 478 sq ft

This floorplan is only for illustrative purposes and is not to scale. Measurements of rooms, doors, windows, and any items are approximate and no responsibility is taken for any error, omission or mis-statement. Icons of items such as bathroom suites are representations only and may not look like the real items. Made with Made Snappy 360.

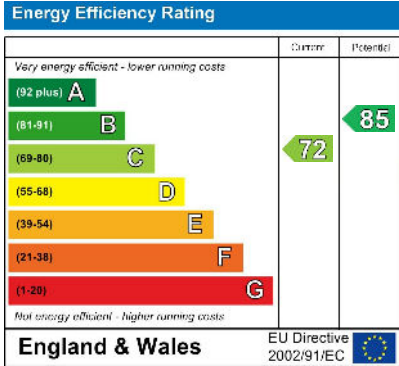

Agents Note: Whilst every care has been taken to prepare these particulars, they are for guidance purposes only. All measurements are approximate and are for general guidance purposes only and whilst every care has been taken to ensure their accuracy, they should not be relied upon and potential buyers/tenants are advised to recheck the measurements



OFFICE ADDRESS
37-39 George Street
Wakefield
West Yorkshire
WF1 1LX

OFFICE DETAILS
01924 200544
wakefield@hodsonsproperty.co.uk
www.hodsonsproperty.co.uk