



HODSONS

OFFERS OVER

£189,995

Back Garden Street

Castleford, WF10 5AL



PROPERTY SUMMARY

We are pleased to offer to the open market, these impressive THREE BEDROOM, THREE STOREY TOWN HOUSES, currently undergoing construction in Castleford, within minutes drive of the M62, Asda Supermarket, Castleford Railway Line and the ever popular Xscape Leisure Facility!

3



2



1







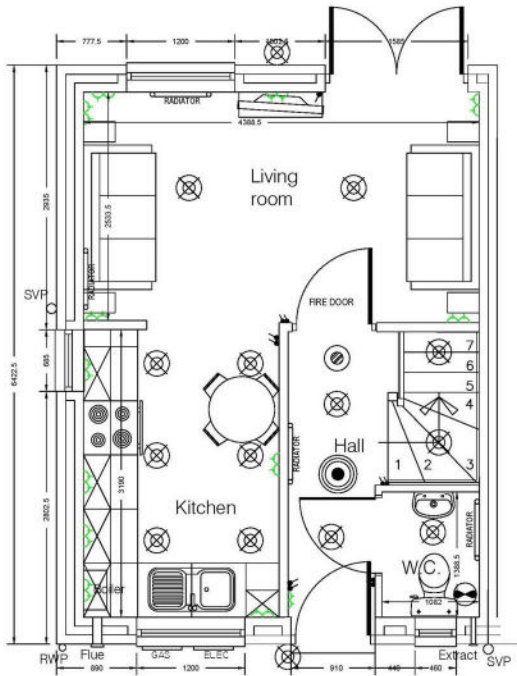

PROPOSED TOWN HOUSE
GROUND FLOOR PLAN
26.5M2 GROSS INTERNAL AREA

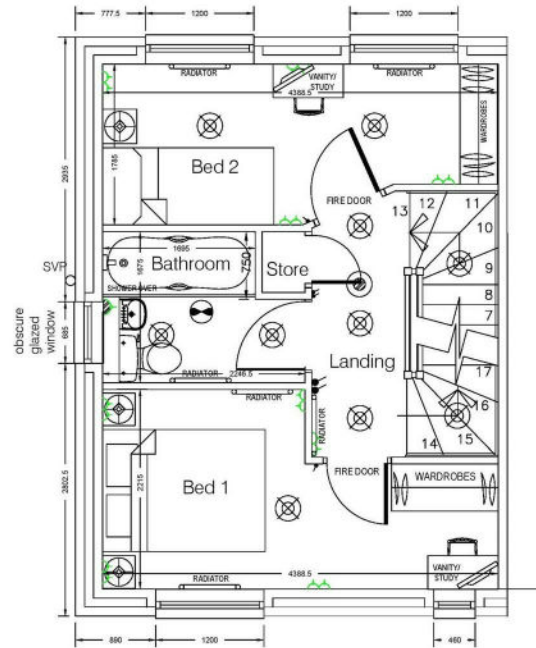

PROPOSED TOWN HOUSE
FIRST FLOOR PLAN
26.5M2 GROSS INTERNAL AREA

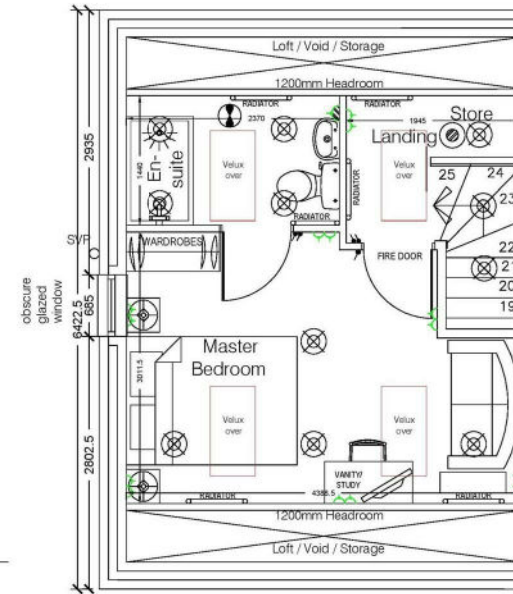

PROPOSED TOWN HOUSE
PART 2ND FLOOR PLAN
21.M2 GROSS INTERNAL AREA



ARCHISMART
DESIGNS LTD

- Architectural design
- Planning & Building Regulations
- Landscape architecture
- 3D Visualisation & Model making

ARCHISMART DESIGNS LTD

CLIENT
MR.SM.TRICKETT

LOCAL AUTHORITY

Wakefield Metropolitan District council

TENURE

Freehold

COUNCIL TAX BAND**VIEWINGS**

By prior appointment only

Energy Efficiency Rating		
	Current	Potential
<i>Very energy efficient - lower running costs</i>		
(92 plus) A		
(81-91) B		
(69-80) C		
(55-68) D		
(39-54) E		
(21-38) F		
(1-20) G		
<i>Not energy efficient - higher running costs</i>		
England & Wales		EU Directive 2002/91/EC 

Agents Note: Whilst every care has been taken to prepare these particulars, they are for guidance purposes only. All measurements are approximate and are for general guidance purposes only and whilst every care has been taken to ensure their accuracy, they should not be relied upon and potential buyers/tenants are advised to recheck the measurements

**OFFICE ADDRESS**

37-39 George Street
Wakefield
West Yorkshire
WF1 1LX

OFFICE DETAILS

01924 200544
wakefield@hodsonsproperty.co.uk
www.hodsonsproperty.co.uk