



HODSONS



OFFERS IN THE REGION OF

£215,000

The Close

Wakefield, WF4 3AQ



HODSONS

PROPERTY SUMMARY

An exceptionally well presented semi detached home, ideal for first time buyers or a couple. The property offers a high level of specification throughout with accommodation briefly comprising; entrance lobby, lounge, dining kitchen with range of contemporary units and appliances. To the first floor are two double bedrooms and a spacious bathroom with modern white suite.

The house has UPVC double glazing, a gas central heating system and low maintenance gardens to front and rear. A drive provides off road parking and in turn leads to a detached single garage.

Conveniently located to access an excellent range of local amenities and the commuter is also well served by the nearby M1 motorway. A viewing of this beautiful semi detached home is strongly recommended.

2



1



1





Approx Gross Internal Area
68 sq m / 735 sq ft

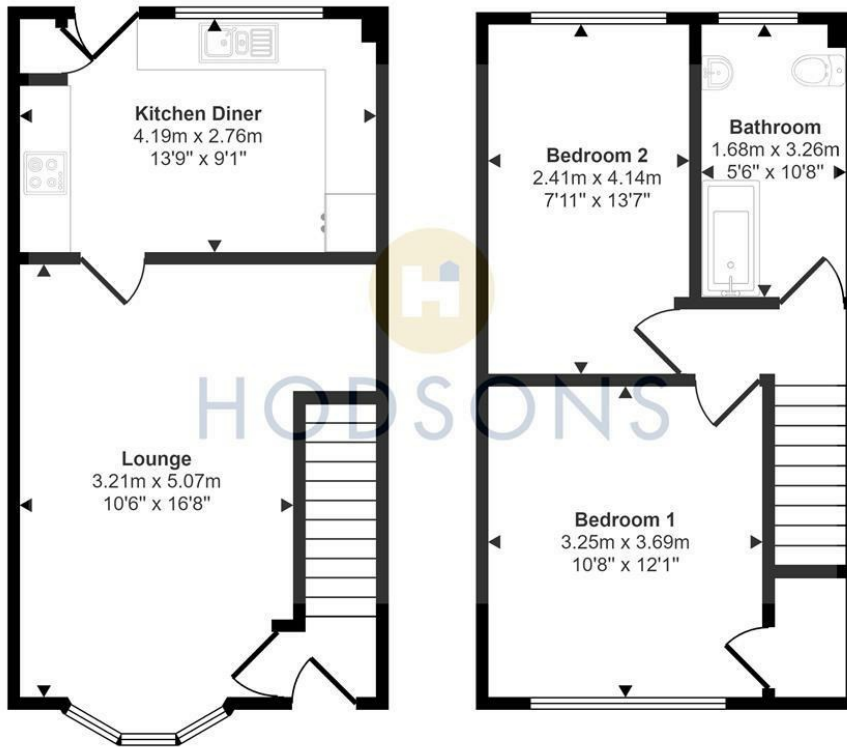

Ground Floor
Approx 34 sq m / 370 sq ft

First Floor
Approx 34 sq m / 365 sq ft

This floorplan is only for illustrative purposes and is not to scale. Measurements of rooms, doors, windows, and any items are approximate and no responsibility is taken for any error, omission or mis-statement. Icons of items such as bathroom suites are representations only and may not look like the real items. Made with Made Snappy 360.

LOCAL AUTHORITY
Wakefield

TENURE
Freehold

COUNCIL TAX BAND
B

VIEWINGS
By prior appointment only

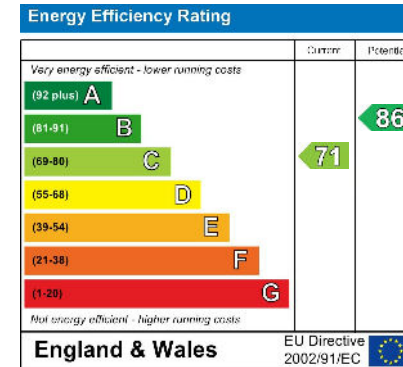

Agents Note: Whilst every care has been taken to prepare these particulars, they are for guidance purposes only. All measurements are approximate and are for general guidance purposes only and whilst every care has been taken to ensure their accuracy, they should not be relied upon and potential buyers/tenants are advised to recheck the measurements



OFFICE ADDRESS
37-39 George Street
Wakefield
West Yorkshire
WF1 1LX

OFFICE DETAILS
01924 200544
wakefield@hodsonsproperty.co.uk
www.hodsonsproperty.co.uk